

LADENKO GLYDA

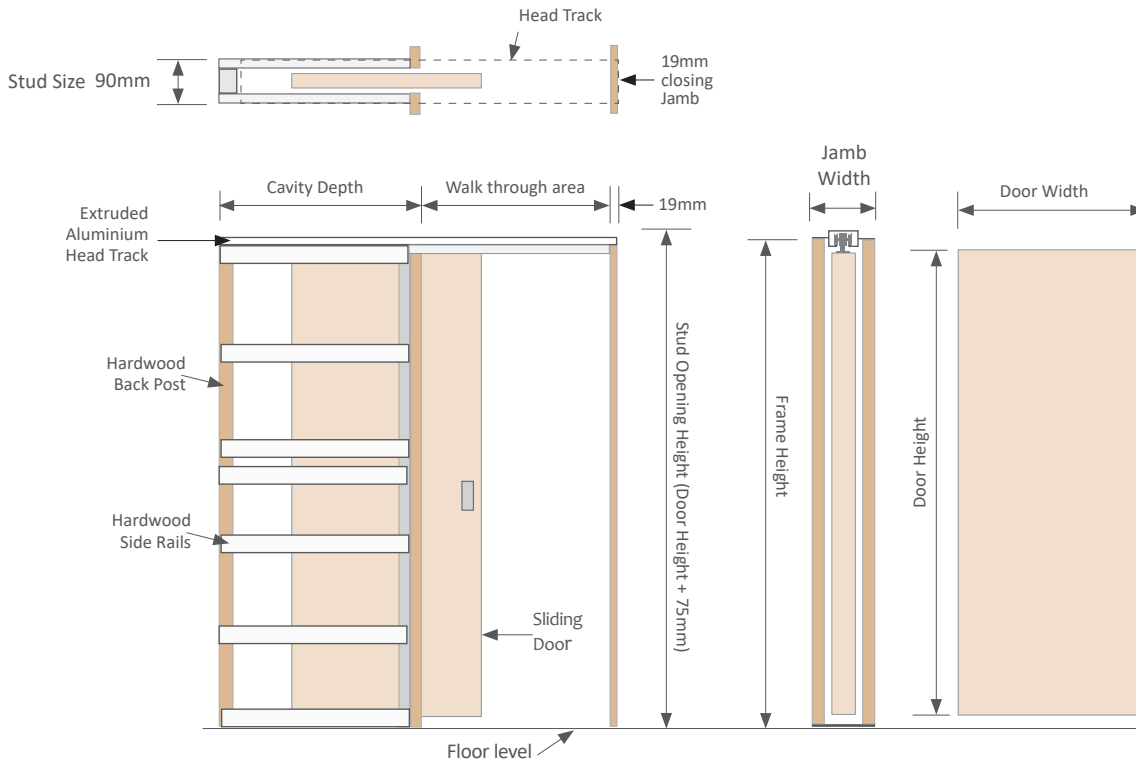

PLEASE NOTE
Door leaf not included as part of the cavity sliding door pocket.
Can be supplied separately.

Please Note: If your door weighs more than 45kg please see our **Spaceline** range

Ladenko Standard Cavity Sliding Door Size and Stud Opening Data

Door Size W x H	Single Stud Opening H x W	Double Stud Opening H x W	Door Size H x W	Single Stud Opening H x W	Double Stud Opening H x W
2040 x 520	2115 x 1100	2115 x 2140	2340 x 520	2415 x 1100	2415 x 2140
2040 x 620	2115 x 1300	2115 x 2540	2340 x 620	2415 x 1300	2415 x 2540
2040 x 720	2115 x 1500	2115 x 2940	2340 x 720	2415 x 1500	2415 x 2940
2040 x 770	2115 x 1600	2115 x 3140	2340 x 770	2415 x 1600	2415 x 3140
2040 x 820	2115 x 1700	2115 x 3340	2340 x 820	2415 x 1700	2415 x 3340
2040 x 870	2115 x 1800	2115 x 3540	2340 x 870	2415 x 1800	2415 x 3540
2040 x 920	2115 x 1900	2115 x 3740	2340 x 920	2415 x 1900	2415 x 3740
2040 x 1020	2115 x 2100	2115 x 4140	2340 x 1020	2415 x 2100	2415 x 4140

Ladenko®

Features and Benefits of the Ladenko Cavity Sliding Door System

- Our frames are available in standard heights & widths, for any project
- Recommended design, fully approved and tested. Quick and easy to install
- Quality quick release hanger system with pelmets pre-drilled and cut to length
- Finished as Architrave or Square Set and quality components and construction.
- Select grade Timber
- Standard 90mm framing.
- Single piece extruded aluminium head-track ensures smooth and quiet operation
- Reinforced 4 wheel door hanger carriage system

Maximum
45kg
Door Weight

For custom made sizes
please refer to our **Spaceline**
80kg range

LADENKO GLYDA

PLEASE NOTE: When square set finish is requested there is no split jamb timber reveals necessary

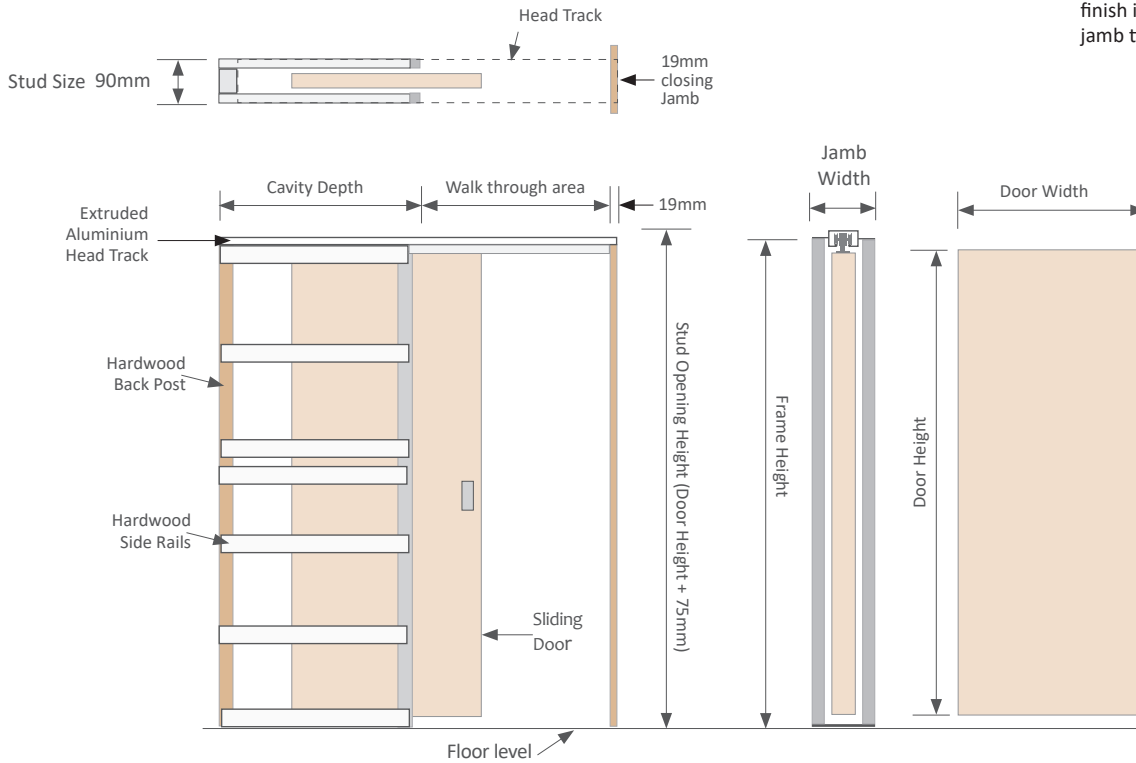

PLEASE NOTE
Door leaf not included as part of the cavity sliding door pocket.
Can be supplied separately.

Please Note: If your door weighs more than 45kg please see our **Spaceline** range

Ladenko Standard Cavity Sliding Door Size and Stud Opening Data

Door Size W x H	Single Stud Opening H x W	Double Stud Opening H x W	Door Size H x W	Single Stud Opening H x W	Double Stud Opening H x W
2040 x 520	2115 x 1100	2115 x 2140	2340 x 520	2415 x 1100	2415 x 2140
2040 x 620	2115 x 1300	2115 x 2540	2340 x 620	2415 x 1300	2415 x 2540
2040 x 720	2115 x 1500	2115 x 2940	2340 x 720	2415 x 1500	2415 x 2940
2040 x 770	2115 x 1600	2115 x 3140	2340 x 770	2415 x 1600	2415 x 3140
2040 x 820	2115 x 1700	2115 x 3340	2340 x 820	2415 x 1700	2415 x 3340
2040 x 870	2115 x 1800	2115 x 3540	2340 x 870	2415 x 1800	2415 x 3540
2040 x 920	2115 x 1900	2115 x 3740	2340 x 920	2415 x 1900	2415 x 3740
2040 x 1020	2115 x 2100	2115 x 4140	2340 x 1020	2415 x 2100	2415 x 4140

Ladenko®

Features and Benefits of the Ladenko Cavity Sliding Door System

- Our frames are available in standard heights & widths, for any project
- Recommended design, fully approved and tested. Quick and easy to install
- Quality quick release hanger system with pelmets pre-drilled and cut to length
- Finished as Architrave or Square Set and quality components and construction.
- Select grade Timber
- Standard 90mm framing.
- Single piece extruded aluminium head-track ensures smooth and quiet operation
- Reinforced 4 wheel door hanger carriage system

Maximum
45kg
Door Weight

For custom made sizes
please refer to our **Spaceline**
80kg range

LADENKO GLYDA

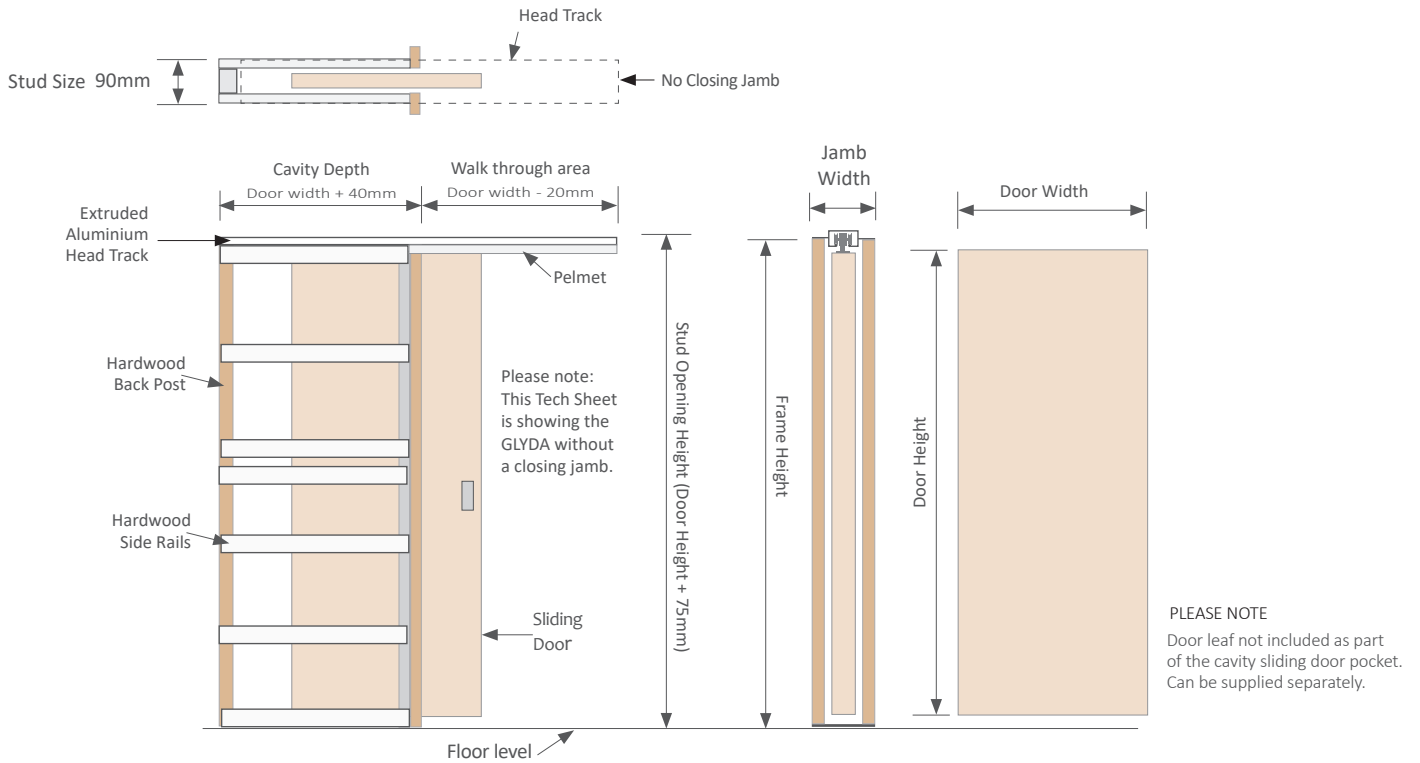

Please Note: If your door weighs more than 45kg please see our **Spaceline** range

Ladenko Standard Cavity Sliding Door Size and Stud Opening Data					
Door Size W x H	Single Stud Opening H x W	Double Stud Opening H x W	Door Size H x W	Single Stud Opening H x W	Double Stud Opening H x W
2040 x 520	2115 x 1100	2115 x 2140	2340 x 520	2415 x 1100	2415 x 2140
2040 x 620	2115 x 1300	2115 x 2540	2340 x 620	2415 x 1300	2415 x 2540
2040 x 720	2115 x 1500	2115 x 2940	2340 x 720	2415 x 1500	2415 x 2940
2040 x 770	2115 x 1600	2115 x 3140	2340 x 770	2415 x 1600	2415 x 3140
2040 x 820	2115 x 1700	2115 x 3340	2340 x 820	2415 x 1700	2415 x 3340
2040 x 870	2115 x 1800	2115 x 3540	2340 x 870	2415 x 1800	2415 x 3540
2040 x 920	2115 x 1900	2115 x 3740	2340 x 920	2415 x 1900	2415 x 3740
2040 x 1020	2115 x 2100	2115 x 4140	2340 x 1020	2415 x 2100	2415 x 4140

Ladenko®

Features and Benefits of the Ladenko Cavity Sliding Door System

- Our frames are available in standard heights & widths, for any project
- Recommended design, fully approved and tested. Quick and easy to install
- Quality quick release hanger system with pelmets pre-drilled and cut to length
- Finished as Architrave or Square Set and quality components and construction.
- Select grade Timber
- Standard 90mm framing.
- Single piece extruded aluminium head-track ensures smooth and quiet operation
- Reinforced 4 wheel door hanger carriage system

Maximum
45kg
Door Weight

For custom made sizes
please refer to our **Spaceline**
80kg range

LADENKO GLYDA

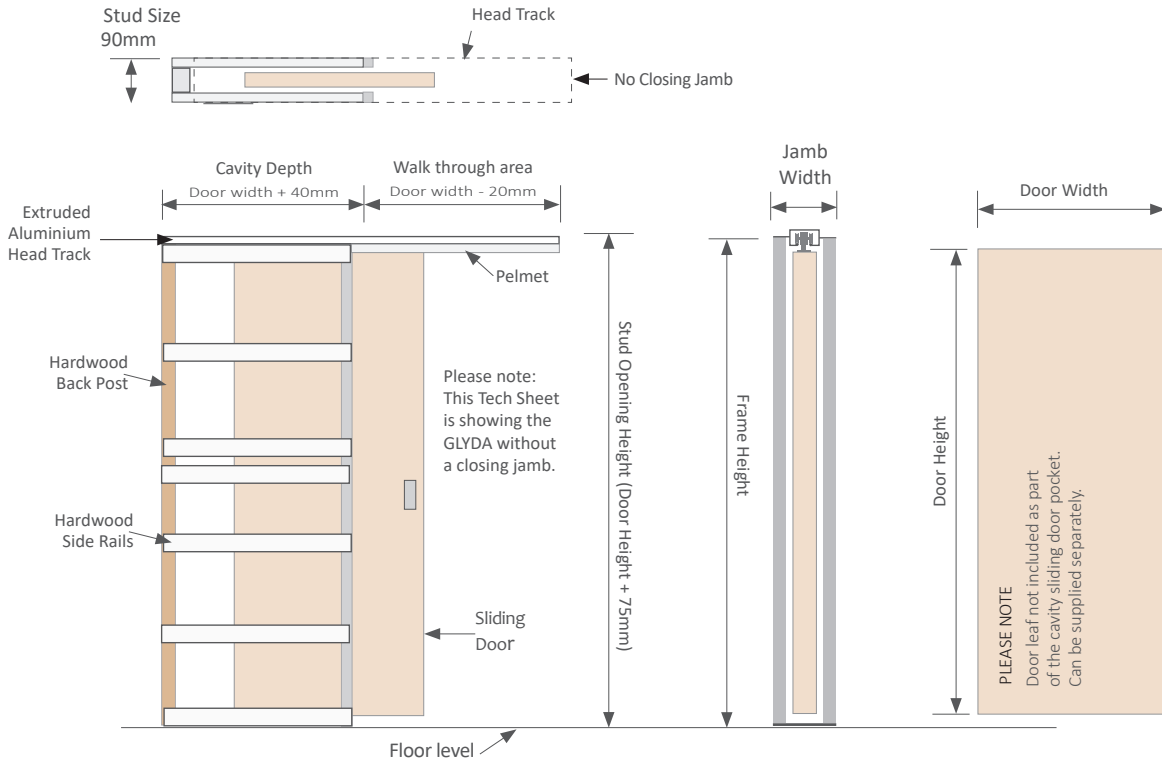

Please Note: If your door weighs more than 45kg please see our **Spaceline** range

Ladenko Standard Cavity Sliding Door Size and Stud Opening Data					
Door Size W x H	Single Stud Opening H x W	Double Stud Opening H x W	Door Size H x W	Single Stud Opening H x W	Double Stud Opening H x W
2040 x 520	2115 x 1100	2115 x 2140	2340 x 520	2415 x 1100	2415 x 2140
2040 x 620	2115 x 1300	2115 x 2540	2340 x 620	2415 x 1300	2415 x 2540
2040 x 720	2115 x 1500	2115 x 2940	2340 x 720	2415 x 1500	2415 x 2940
2040 x 770	2115 x 1600	2115 x 3140	2340 x 770	2415 x 1600	2415 x 3140
2040 x 820	2115 x 1700	2115 x 3340	2340 x 820	2415 x 1700	2415 x 3340
2040 x 870	2115 x 1800	2115 x 3540	2340 x 870	2415 x 1800	2415 x 3540
2040 x 920	2115 x 1900	2115 x 3740	2340 x 920	2415 x 1900	2415 x 3740
2040 x 1020	2115 x 2100	2115 x 4140	2340 x 1020	2415 x 2100	2415 x 4140

Ladenko®

Features and Benefits of the Ladenko Cavity Sliding Door System

- Our frames are available in standard heights & widths, for any project
- Recommended design, fully approved and tested. Quick and easy to install
- Quality quick release hanger system with pelmets pre-drilled and cut to length
- Finished as Architrave or Square Set and quality components and construction.
- Select grade Timber
- Standard 90mm framing.
- Single piece extruded aluminium head-track ensures smooth and quiet operation
- Reinforced 4 wheel door hanger carriage system

Maximum
45kg
Door Weight

For custom made sizes
please refer to our **Spaceline**
80kg range

LADENKO GLYDA

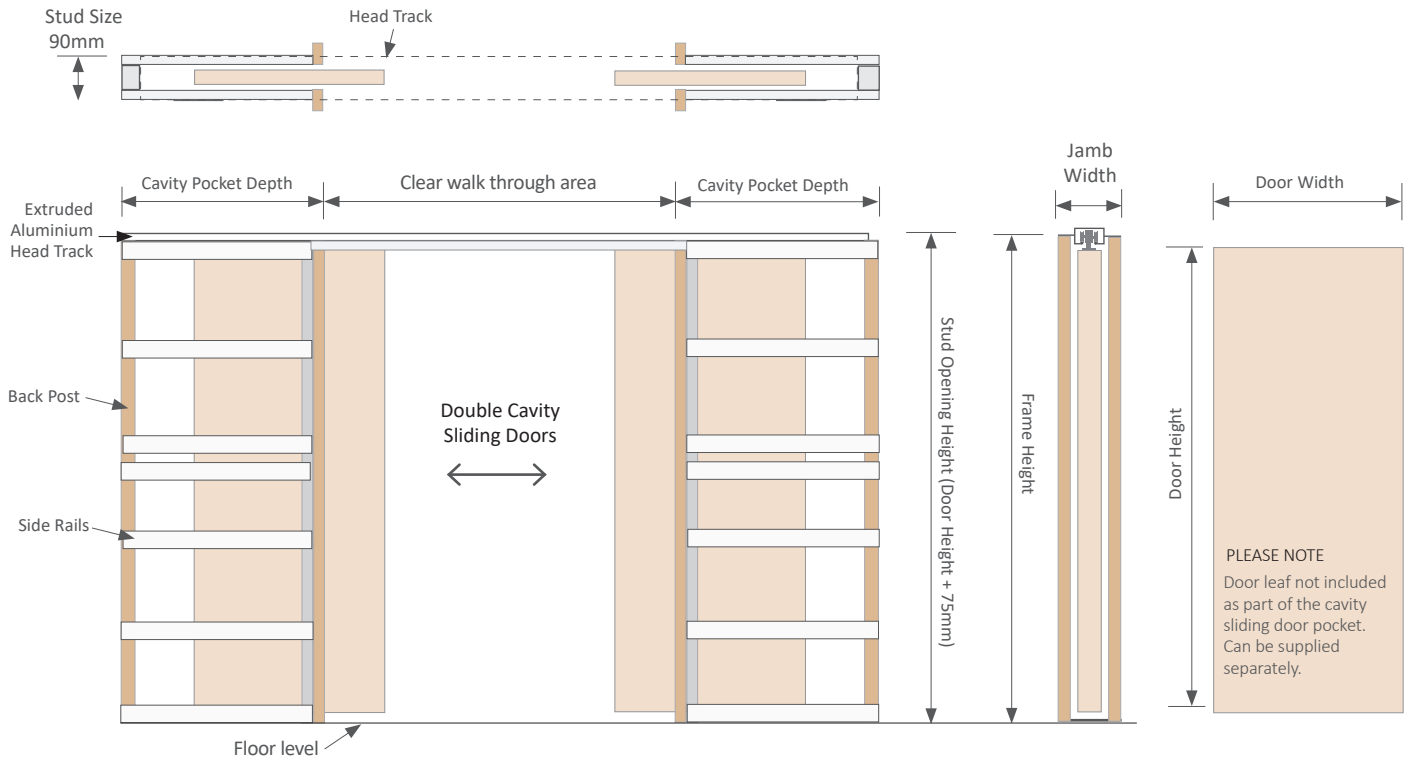

Please Note: If your door weighs more than 45kg please see our **Spaceline** range

Ladenko Standard Cavity Sliding Door Size and Stud Opening Data					
Door Size W x H	Single Stud Opening H x W	Double Stud Opening H x W	Door Size H x W	Single Stud Opening H x W	Double Stud Opening H x W
2040 x 520	2115 x 1100	2115 x 2140	2340 x 520	2415 x 1100	2415 x 2140
2040 x 620	2115 x 1300	2115 x 2540	2340 x 620	2415 x 1300	2415 x 2540
2040 x 720	2115 x 1500	2115 x 2940	2340 x 720	2415 x 1500	2415 x 2940
2040 x 770	2115 x 1600	2115 x 3140	2340 x 770	2415 x 1600	2415 x 3140
2040 x 820	2115 x 1700	2115 x 3340	2340 x 820	2415 x 1700	2415 x 3340
2040 x 870	2115 x 1800	2115 x 3540	2340 x 870	2415 x 1800	2415 x 3540
2040 x 920	2115 x 1900	2115 x 3740	2340 x 920	2415 x 1900	2415 x 3740
2040 x 1020	2115 x 2100	2115 x 4140	2340 x 1020	2415 x 2100	2415 x 4140

Ladenko®

Features and Benefits of the Ladenko Cavity Sliding Door System

- Our frames are available in standard heights & widths, for any project
- Recommended design, fully approved and tested. Quick and easy to install
- Quality quick release hanger system with pelmets pre-drilled and cut to length
- Finished as Architrave or Square Set and quality components and construction.
- Select grade timber jambs & pelmets.
- Standard 90mm framing.
- Single piece extruded aluminium head-track ensures smooth and quiet operation
- Reinforced 4 wheel door hanger carriage system

Maximum
45kg
Door Weight

For custom made sizes please refer to our **Spaceline** 80kg range

LADENKO GLYDA

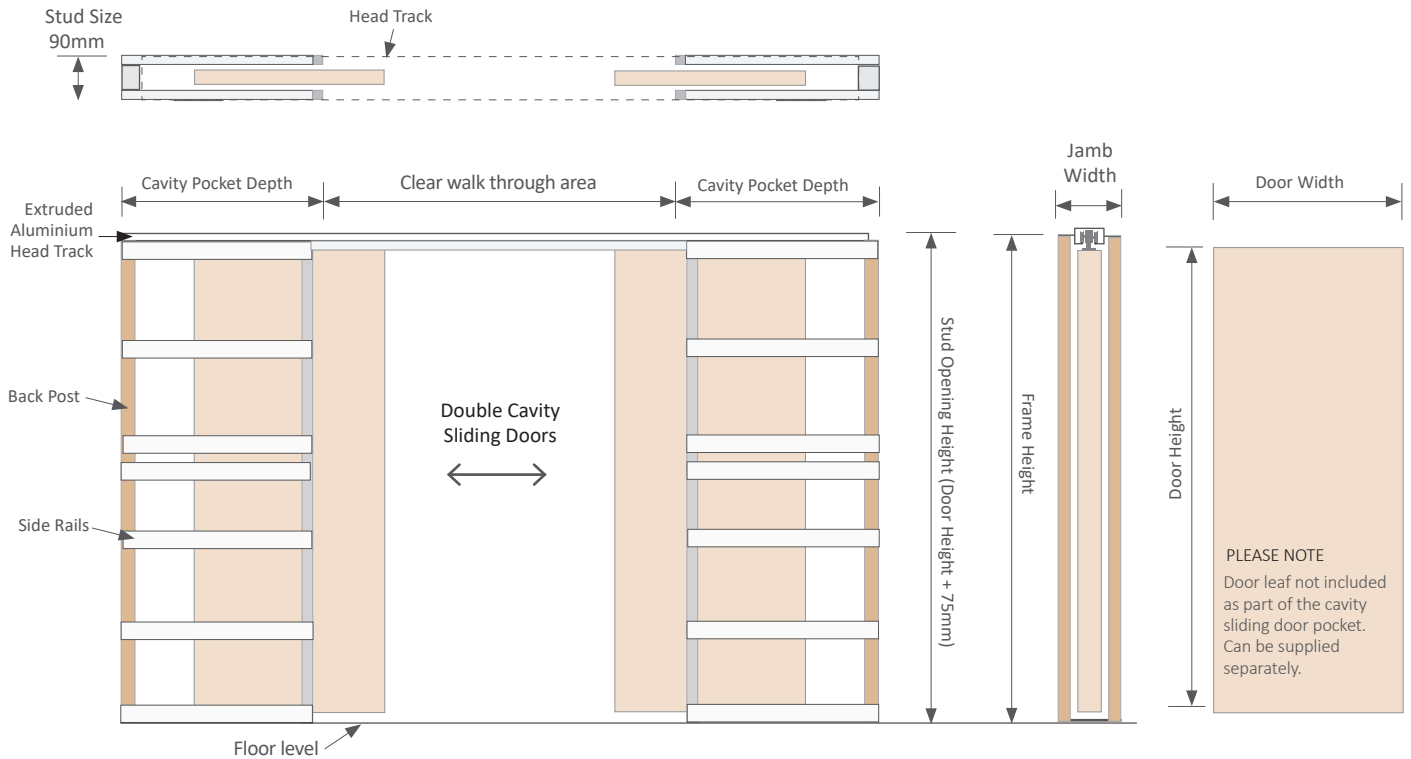

Please Note: If your door weighs more than 45kg please see our **Spaceline** range

Ladenko Standard Cavity Sliding Door Size and Stud Opening Data					
Door Size W x H	Single Stud Opening H x W	Double Stud Opening H x W	Door Size H x W	Single Stud Opening H x W	Double Stud Opening H x W
2040 x 520	2115 x 1100	2115 x 2140	2340 x 520	2415 x 1100	2415 x 2140
2040 x 620	2115 x 1300	2115 x 2540	2340 x 620	2415 x 1300	2415 x 2540
2040 x 720	2115 x 1500	2115 x 2940	2340 x 720	2415 x 1500	2415 x 2940
2040 x 770	2115 x 1600	2115 x 3140	2340 x 770	2415 x 1600	2415 x 3140
2040 x 820	2115 x 1700	2115 x 3340	2340 x 820	2415 x 1700	2415 x 3340
2040 x 870	2115 x 1800	2115 x 3540	2340 x 870	2415 x 1800	2415 x 3540
2040 x 920	2115 x 1900	2115 x 3740	2340 x 920	2415 x 1900	2415 x 3740
2040 x 1020	2115 x 2100	2115 x 4140	2340 x 1020	2415 x 2100	2415 x 4140

Ladenko®

Features and Benefits of the Ladenko Cavity Sliding Door System

- Our frames are available in standard heights & widths, for any project
- Recommended design, fully approved and tested. Quick and easy to install
- Quality quick release hanger system with pelmets pre-drilled and cut to length
- Finished as Architrave or Square Set and quality components and construction.
- Select grade timber jambs & pelmets.
- Standard 90mm framing.
- Single piece extruded aluminium head-track ensures smooth and quiet operation
- Reinforced 4 wheel door hanger carriage system

Maximum
45kg
Door Weight

For custom made sizes please refer to our **Spaceline** 80kg range

Application

Suitable for interior, top hung sliding panels.

Ideal for sliding panels and shutters in residential and commercial applications. Versatile design allows the opening to be covered by any number of panels.

The aluminium track may be fitted directly to the lintel, in single or multiple lines, or face fitted to the lintel using a single line of brackets. Fascia accessory with end caps also available.

Hangers come standard with a steel bracket and four nylon tyred wheels with precision bearings. Clip stops provided but can be upgraded to a soft close device for improved operation.

Panel Specification

Track System:	Single Run 60
For Individual Panels:	
Max Panel Weight	60kg
Max Panel Height	2400mm
Min Panel Thickness	19mm

Standard Sets and Packs

Sets comprise of top track, brackets, hangers, clip stops or soft closes, guide, spanner and timber screws.

Set No.	Panel width	Track Length	Qty Brackets
SR60-20/1	610mm to 915mm	2000mm	5
SR60-30/1	915mm to 1525mm	3000mm	8
SR60-S20/1	610mm to 915mm	2000mm	5
SR60-S30/1	915mm to 1525mm	3000mm	8

Pack No.	
SR60-1PK	Fitting pack only, no track and brackets

Hardware Specification

Track:	60A
Material	Aluminium, Mill
Standard lengths	2000mm, 3000mm, 4000mm and 6000mm

Brackets:	
Single	91
Pack of 5 brackets	91/5

Bracket 91 made from stainless steel. Supplied with matching fasteners.

Hangers (2 per panel):	607
-------------------------------	-----

Hanger has a nylon body and comes standard with zinc plated steel bracket and four nylon tyred wheels with chrome precision bearings.

Clip Stops:	60CS
Adjustable clip stop made from POM, an engineered thermoplastic.	

Guide:	55G
Guide in white nylon, comes in two parts that fit on both sides of the panel. The guide is floor mounted.	

Spanner:	805-SPN to suit 607 Hanger.
-----------------	-----------------------------

Accessories:	
Soft Close	60SCT
Suitable for panels up to 60 kg.	

Fascia and End Caps	63
Aluminium fascia available in 2000mm and 3000mm lengths in powder coat white or clear anodised.	

Alternative Guide	801
-------------------	-----

Spring loaded guide, nylon body and tip with zinc plated steel shaft. Designed to slide in the 92 and 130 thresholds.

Alternative Guide	101N
-------------------	------

The nylon guide is designed to slide through a 20mm deep by 5mm wide sawcut in the bottom rail of the panel.

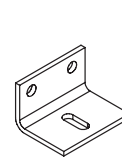
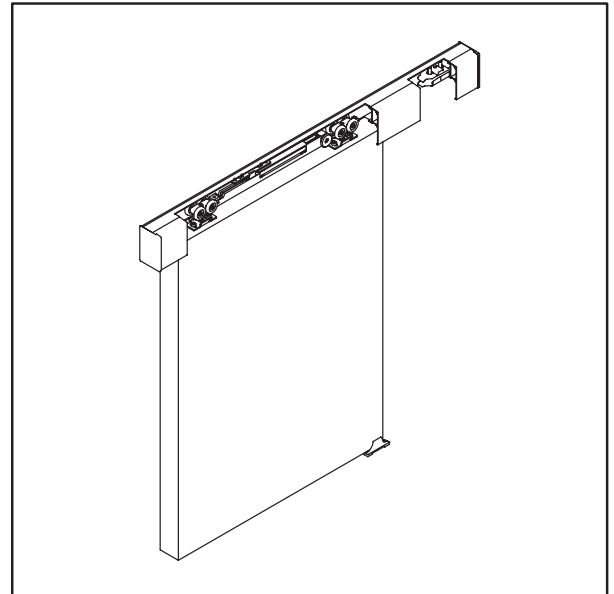

No. 91
BRACKET

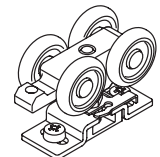

No. 607
HANGER

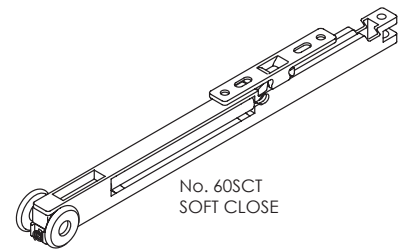

No. 60SCT
SOFT CLOSE

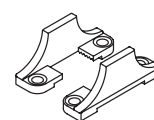

No. 55G
GUIDE
(SUPPLIED IN
SETS & PACKS)

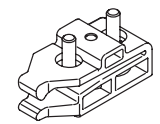

No. 60CS
CLIP STOP
(SUPPLIED IN
SETS & PACKS)



No. 801
GUIDE

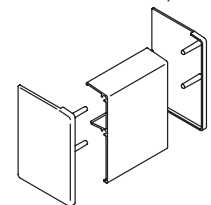

No. 63
FASCIA

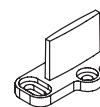

No. 101N
GUIDE

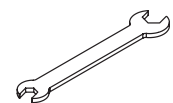

No. 805-SPN
SPANNER

91LS BRACKETS

Track Length	2000	3000	4000	6000
Bracket Qty.	5	8	10	15

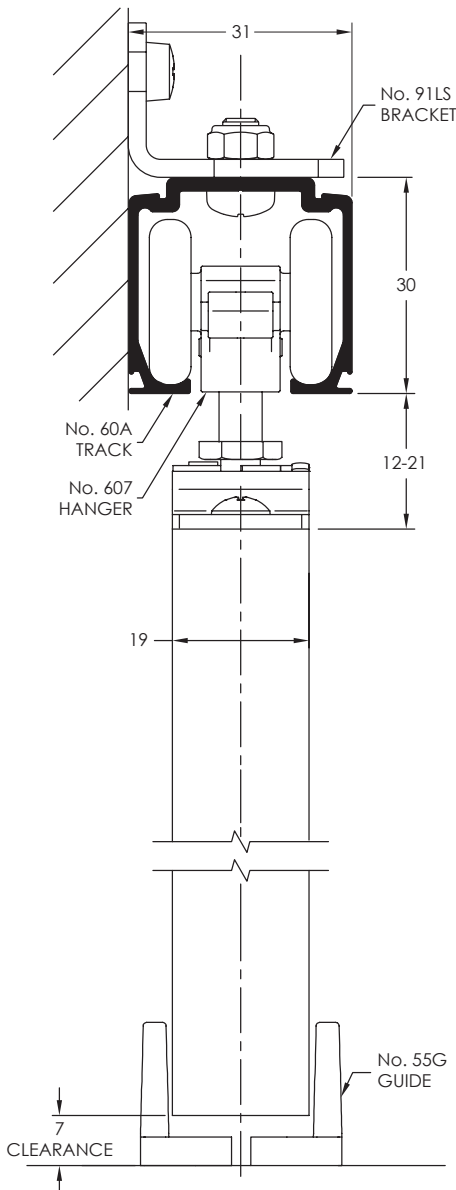

INSTALLATION INSTRUCTIONS

POSITION 1 (CLIP STOP)

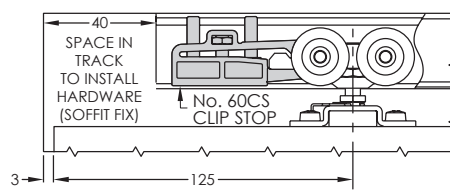

POSITION 2 (SOFT CLOSE)

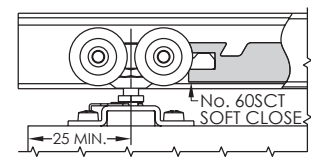

- 1** Fix Track Parallel to Floor
Soffit Fix: position 8g screws first 50mm in from each end and every 450mm approx centres
Face Fix: use 91 brackets.
- 2** Attach Hardware to Panel
Hanger mounting plates should be positioned centrally to panel thickness
- 4** Fit Panel
Insert hardware into track.
With the latch on the mounting plates open, bring door up to hangers and push hanger bolt into plate. Close latches when bolts are in the plates.
- 5** Adjust Panel
Screw bolt in or out of hanger to adjust panel height. Adjust height so panel is square.
- 6** Fit Guide
Locate at opening jamb. With panel hanging plumb fix guides to either side of panel.
- 7** Fit Clip Stops or Soft Closes
Clip Stop - 1 each end. Outer screws fixing. Inner screw adjusts strength of clipping.
Soft close - install as per INST60SCT.

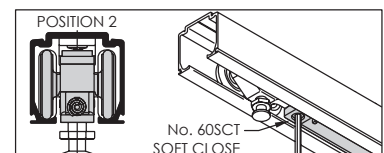
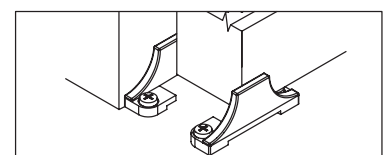
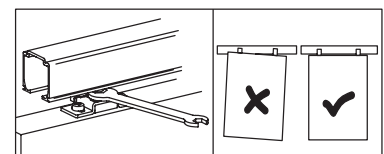
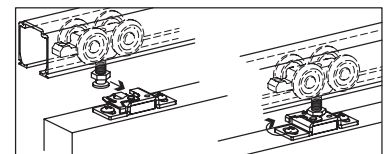
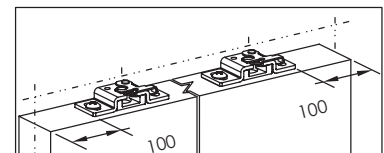
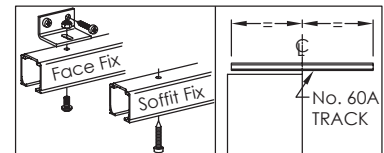

ALTERNATIVE GUIDES

